

WIRING

**165 MODEL
WIRING DIAGRAM KEY**

- B. Conduit (two wire) - Red wire with black tracer and black
- C. Conduit (four wire) - Red, green, yellow and black
- D. Conduit (four wire) - Red, green, yellow and black
- E. Conduit (two wire) - Green and red
- F. Conduit (three wire) - 2 Red and one yellow
- G. Conduit (four wire) - Red, green, yellow and black
- H. Conduit (one wire) - Red

- 1. Switch terminal - Red wire
- 2. Switch terminal - Yellow wire
- 3. Switch terminal - Not used with standard wiring
- 4. Switch terminal - Green wire
- 5. Switch terminal - Black wire
- 6. Headlamp - Red and green wires
- 7. Horn button - Black wire, green wire (rubber mounted handlebars only)
- 8. Terminal plate - Mounted on ignition coil
- 9. Junction terminal - Red wire with black tracer and yellow wire
- 10. Ignition coil - 2 Black wires
- 11. Generator and circuit breaker - See items 13, 14, 15, and 16

- 12. Voltage regulator - 2 Red wires, green, yellow, black wire
- 13. Circuit breaker terminal - Black wire
- 14. Ground terminal - Yellow wire
- 15. Generator terminal - Red wire
- 16. Generator terminal - Green wire
- 17. Junction terminal - 2 Black wires
- 18. Junction terminal - 2 Green wires
- 19. Horn - 3 Red wires, yellow wire
- 20. Battery positive terminal - 2 Red wires
- 21. Battery negative terminal - Black wire
- 22. Stop lamp switch - 2 Red wires
- 23. Tail and stop lamp - Green, red wires
- 24. Rear fender - Insulated terminals 17 and 18
- 25. Junction terminal - Black, yellow wires
- 26. Ignition-light switch - See items 1, 2, 3, 4, and 5
- 27. Handlebar Headlamp Switch - Black wire with red tracer, red wire with black tracer, red wire with yellow tracer
- 28. Fuse
- 29. Connector
- 30. Connector

KEY TO COLOR CODE

- (R) RED
- (G) GREEN
- (B) BLACK
- (Y) YELLOW
- (RB) RED WITH BLACK TRACER

Letters in identify cables and conduit housed wires

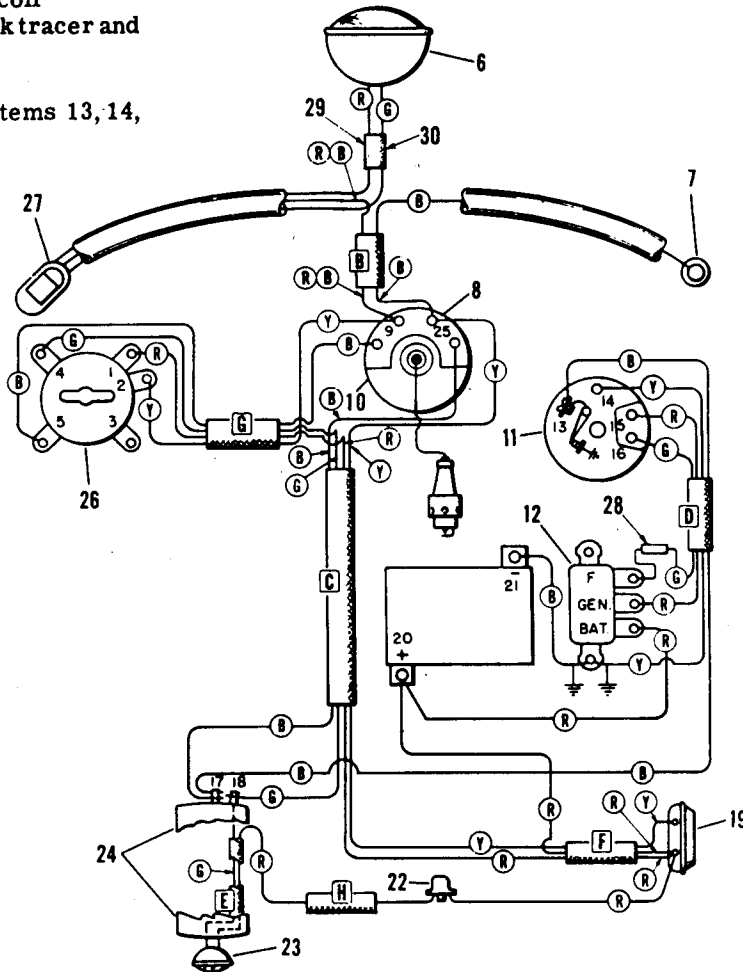

Figure 5B-4. Model 165 Wiring Diagram

**HUMMER MODEL
WIRING DIAGRAM KEY**

- A. Conduit (two wires) - Red, green
- . Conduit (two wires) - Red, green
- J. Conduit (two wires) - Red, green
- E. Conduit (two wires) - Yellow, green

- B. Switch terminal - Red wire
- 1. Switch terminal - Green wire
- 2. Switch terminal - Green wire

- 3. Switch terminal - Red wire
- 4. Light switch (Backside view)
- 5. Light switch (Operating side view)
- 6. Headlamp - Red and green wires
- 7. Magneto-generator
- 8. Junction terminal on rear fender - 2 Green wires
- 9. Rear fender
- 10. Tail and stop lamp - Green and red wires
- 11. Knife terminal wire connection with plastic insulator
- 12. Stop lamp switch - 2 Red wires
- 13. Ignition (spark) coil - Yellow and green wires

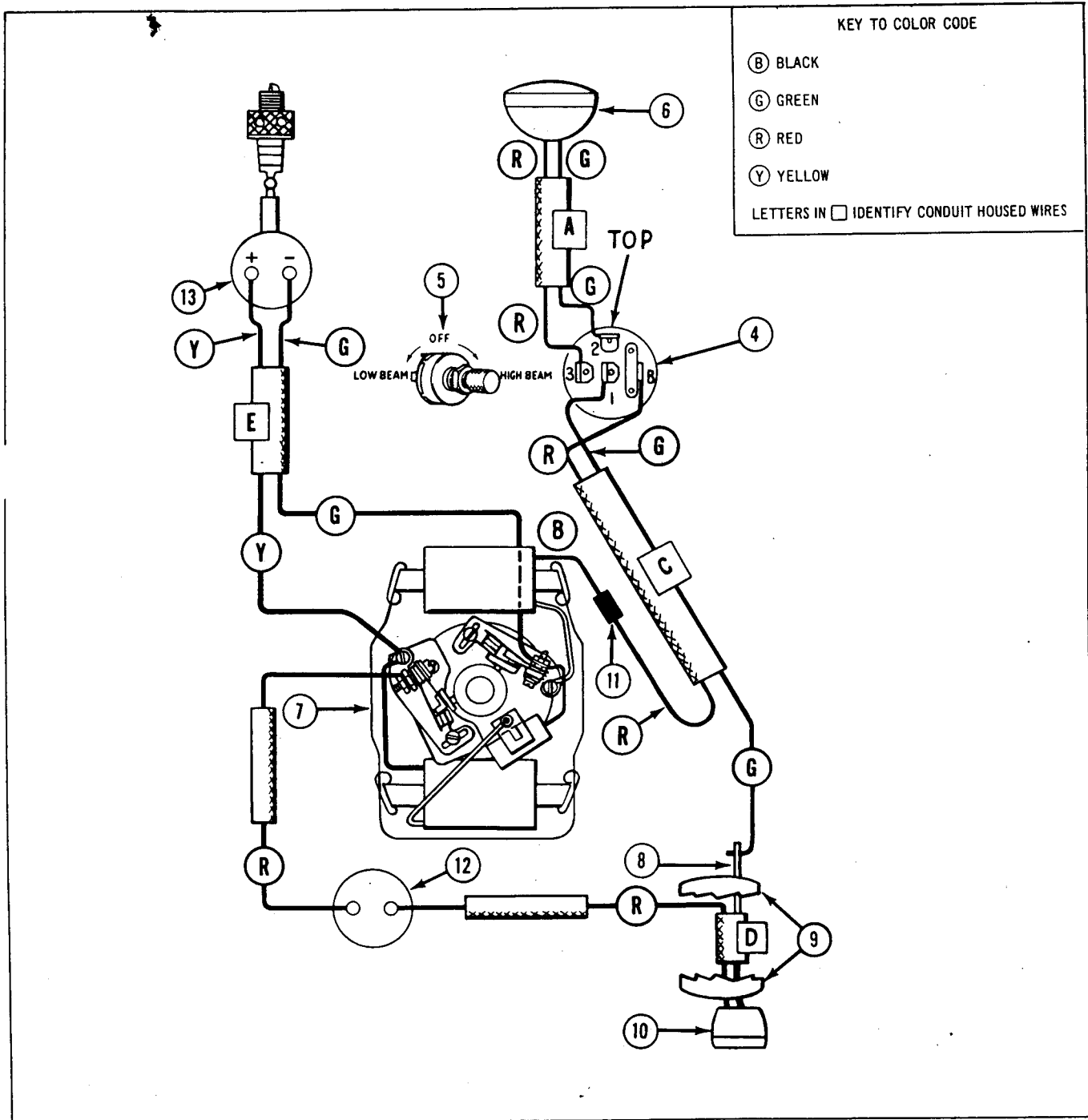

Figure 5B-5. Hummer Wiring Diagram

WIRING

WIRING DIAGRAM KEY

- A. Conduit (two wires) - Red, green
- C. Conduit (two wires) - Red, green
- D. Conduit (two wires) - Red
- E. Conduit (two wires) - Yellow, green
- F. Conduit (one wire) - Red
- B. Switch terminal - Red wire
- 1. Switch terminal - Green wire
- 2. Switch terminal - Green wire
- 3. Switch terminal - Red wire
- 4. Light switch (Backside view)
- 5. Headlamp - Red and green wires
- 6. Magneto-generator
- 7. Junction terminal on rear fender - red wire
- 8. Junction terminal on rear fender - green wire
- 9. Rear fender
- 10. Tail and stop lamp - Green and red wires
- 11. Knife terminal wire connection with plastic insulator
- 12. Stop lamp switch - 2 Red wires
- 13. Ignition (spark) coil - Yellow and green wires
- 14. Horn - 2 Red and 1 black wire
- 15. Horn Button - Black and green wire
- 16. Spark plug

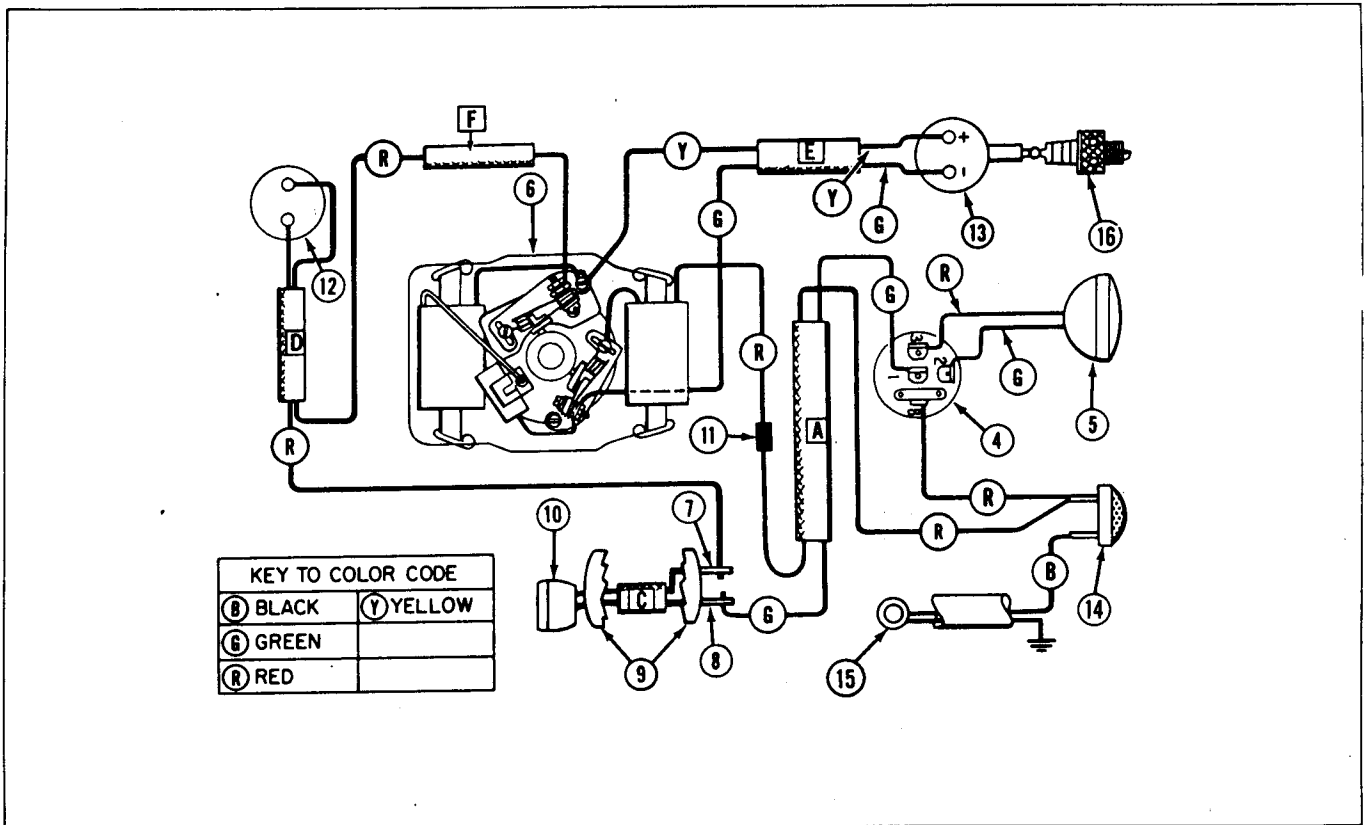
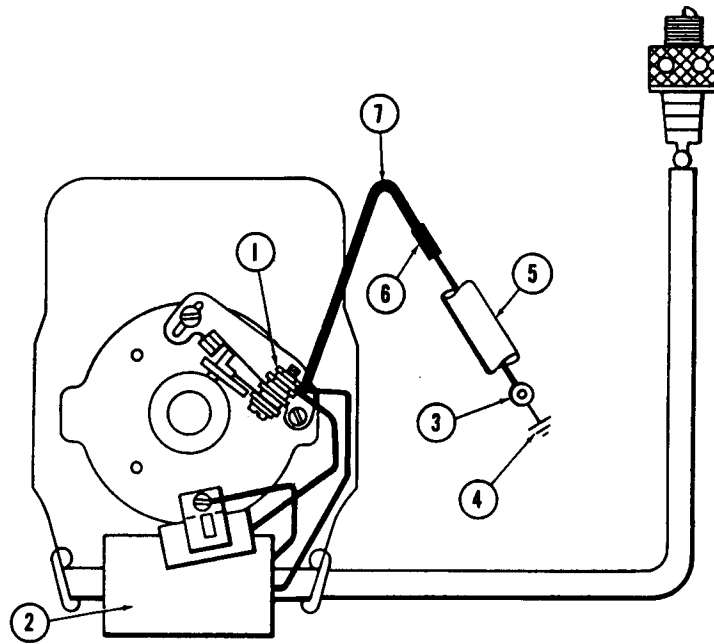
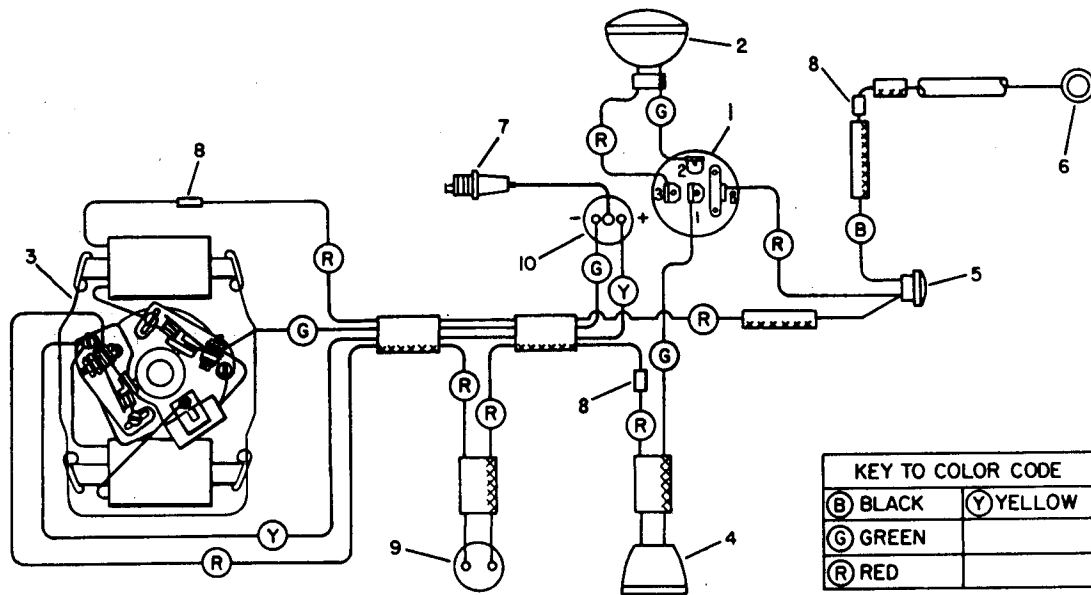

Figure 5B-9. 1960 and 1961 Super-10, 1962 to 1965 BT, BTU, BTH Wiring Diagram



- 1 Terminal
- 2 Ignition coil
- 3 Magneto cutout button
- 4 Ground
- 5 Handlebar
- 6 Knife terminal wire connection with plastic insulator
- 7 Single wire for magneto cutout button on handlebar.

Figure 5B-9A. 1962 Ranger (BTF) Wiring Diagram



- 1 Light switch (backside view)
- 2 Headlamp
- 3 Magneto-generator
- 4 Tail and stop lamp

- 5 Horn
- 6 Horn handlebar button
- 7 Spark plug

- 8 Connector
- 9 Stop lamp switch
- 10 Ignition (spark) coil

Figure 5B-9B. 1966 Bobcat Wiring Diagram